

# ORWAK

## 4240 • 4360

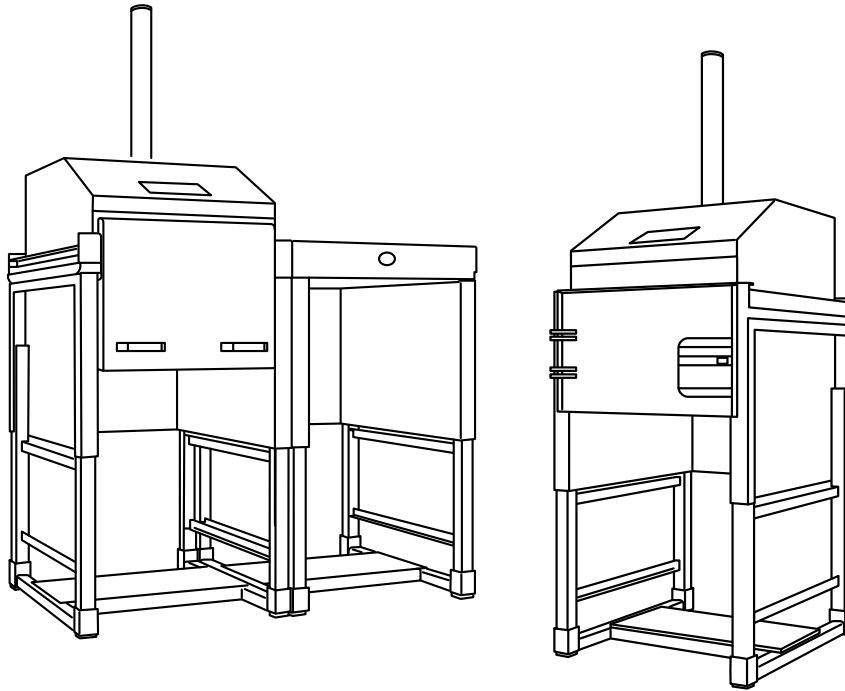

ORIGINAL OPERATING INSTRUCTIONS



# English

## CONTENTS

Safety information.....	4
Parts of the machine.....	5
Safety.....	6
Control panel.....	7
Operating instruction.....	8
Weekly inspection and maintenance.....	9
Technical specification....	10
Dimensional drawing.....	11
Transport.....	12
Installation.....	13
CE.....	14

Electrical diagram

Hydraulic diagram

## IDENTIFICATION

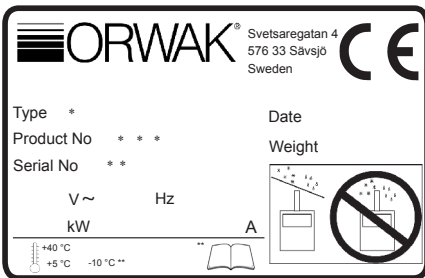

- \* - XXXX (ex Compactor 4240)
- \*\* - XXXXXX (ex 121001)
- \*\*\* - 490XXXX - XX (ex 4904240-00)

You find the serial number on the baler.  
For any inquiries, please indicate the type and serial number of the baler.

# English

## OPERATOR WARNING & DUTY

This manual must be available permanently near the baler. Each operator must read and follow the full instruction of this manual before being authorize.

All operator must absolutely study and fully understand the operator's manual, specifically pay a particular attention to the safety procedure section.

In case of misunderstanding or doubt, do not start the machine. Contact support service.

Operators and service staff must comply by wearing personal protective equipment (PPE) before using or performing any maintenance operation following rule and regulation code.



Operator and service personal must be trained during the commissioning on the baler operation, by a duly authorized person from the manufacturer.

To avoid any mistake or accident, all operators must understand the operator manual.



All operators must absolutely study and fully understand the operator's manual. This manual must remain available for any personal involve with the baler.

## SAFETY SIGN - In the manual



Warning !



During inspection and maintenance, servicing and removal of trapped waste. Disconnect the power to the machine by removing the plug from the wall socket.



Do not flush water on the baler.

## SAFETY SIGN - On the baler



Danger High Voltage



Warning! Beware of your hand when the machine is in motion.



Warning! Beware of your foot when the machine is in motion.

PARTS OF THE MACHINE

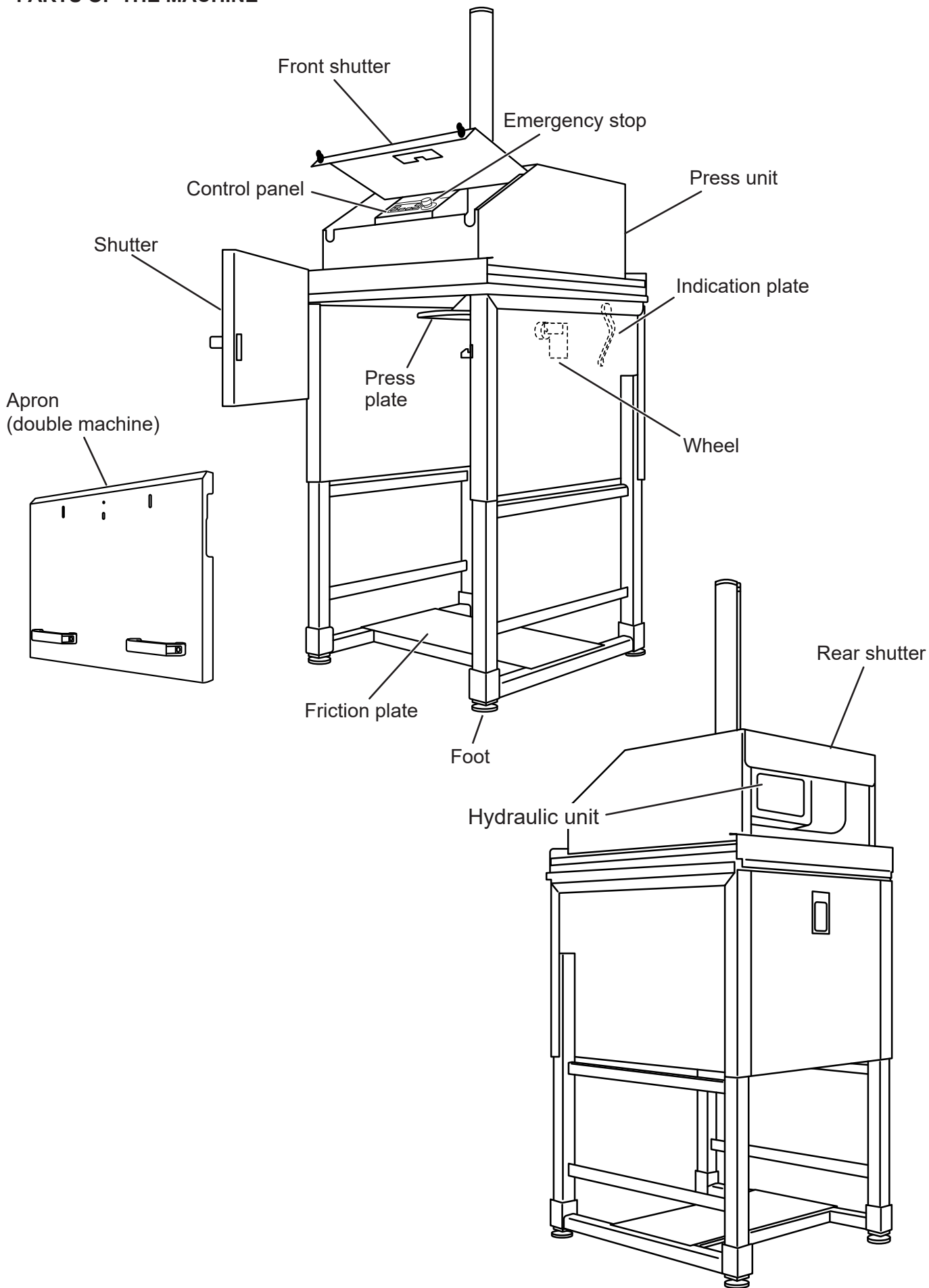

## SAFETY

Please read the operating instructions **BEFORE** operating the machine.

Our warranty/product responsibility requires that:

- instructions are followed, and that no conversion or modification is carried out.
- original spare parts, and hydraulic oils and lubricants recommended by the machine manufacturer are used.
- at least one annual service is carried out.

*The user of the machine is responsible for the safety checks, and for ensuring that daily maintenance of the machine is carried out.*

*The user is responsible for making sure that defects are rectified, and that neither the user nor other people are exposed to danger.*

*The owner is responsible for ensuring that all laws and instructions are complied with when using the machine.*



**This symbol means WARNING or DANGER – personal safety instruction!**



This machine is designed for **ONE-MAN OPERATION**.

Only the operator is allowed in the working area of the machine. The working area is defined under the heading **Technical data; Recommended space for machine in operation**.



The machine must not be operated if the safety features (e.g. breakers and guards) have been deactivated, damaged or removed.

Lost or damaged parts must be replaced with **original spare parts**.



The machine may only be operated by a person who has received training and has experience with the machine.



The machine has a **high centre of gravity**, handle the machine with caution when moving. The area immediately around the machine and its base should be completely level.



Installation, repair and service must only be performed by **qualified and competent** personnel, and in accordance with the installation and service instructions.



The machine **must not** be used by minors.



**Never** climb on the machine!



Avoid compacting materials of different hardness in the machine at the same time. (If the waste has not been properly mixed and distributed well in the chamber, it can result in an uneven load on the press plate and damage to the machine).



The machine should be anchored at the time of installation.

## SAFETY FEATURES

The machine is equipped with the following safety features: a breaker switch that prevents the machine from being used when the upper door is open; mechanical door interlocks, and guards and doors to protect against dangerous intervention in the machine. The machine is also equipped with an **emergency stop**. *The above safety features must be checked regularly; see section on **weekly inspection and maintenance**.*

## RANGE OF APPLICATION

The machine is a hydraulically operated baler intended for compacting bulky materials such as cardboard, paper and plastic. The machine may only be used in areas that have a roof, protection against wind, and normal lighting. The machine is intended for use within the temperature range -10°C to +40°C.

A low-temperature oil and/or heater should be used at temperatures lower than +5°C.

Materials that are **flammable** or of an **explosive** nature, such as pressurised containers or the like, which could cause injury, damage, fire or an explosion if exposed to pressure or sparks, **must not be** compacted in the machine.

## CONTROL PANEL

### Temperature lights

**Blue lights** indicate that the machine is cold.

The machine can still be operated.

**Red light** indicates that the machine has overheated and CANNOT be operated until it has returned to its normal temperature and the light has gone out.

**Voltage light** - this light indicates that there is power to the machine.

### PAPER/PLASTIC

- this feature is not used, since this machine presses different types of materials at the same time.

### Bale light

- this feature is not used on this machine.

### Service light

- see under TROUBLESHOOTING below for more information.

### MAN/AUTO

- this feature is not used. To start a compaction cycle, the start button must be pressed.

**Bale size** - this feature is not used on this machine.

**Arrow up** - used to raise the press plate to its normal position.

**Arrow down** - used to lower the press plate. The press plate stops in its down position.

**Start** - starts a compaction cycle.

**Steady light** - the machine is ready for use.

**Blinking light** - the door must be opened and closed for the press cycle to be able to start.

### Emergency stop

- used if a compaction cycle has to be stopped immediately. The LED lights when the emergency stop is pressed. If the LED remains lit when the emergency stop is cancelled, there is a fault in the machine. Call an authorised technician.

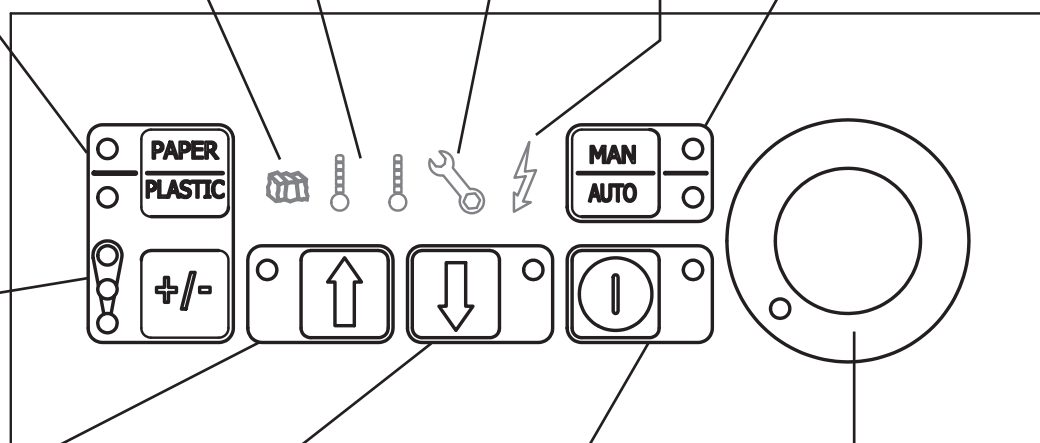

## TROUBLESHOOTING

Flashing service light = fault.

Fault messages can be read via the service light.

First, try removing the plug from the mains and then plugging it back in.

If the fault persists and the service key flashing again don't turn of the power: instead press the emergency stop button, after some seconds there will be a number of flash-es, e.g. LED extinguished for 5,10 or 15 seconds followed by 1 to 9 flashes. (Example 5 second 3 flash or 10 seconds 2 flash.)

For optimal service help – mention the flashing message when reporting the fault.

Do not use the machine until an authorised service engineer has corrected the fault.

Service light, steady light = time for servicing. Contact your authorised service engineer.

The machine can continue to be operated.

# English

## OPERATING INSTRUCTIONS

### WARNING!

Only the operator is allowed in the working area of the machine!

### SINGLE

#### Compaction

Lock the front shutter before start.

- 1 Distribute the waste evenly inside the bin.
- 2 Place the bin in the machine and close the door. The start button will glow green - press the start button for a compaction cycle.

#### Empty bin

- 3 Open the door and pull out the bin.
- 4 Empty the bin and put it back in the machine.

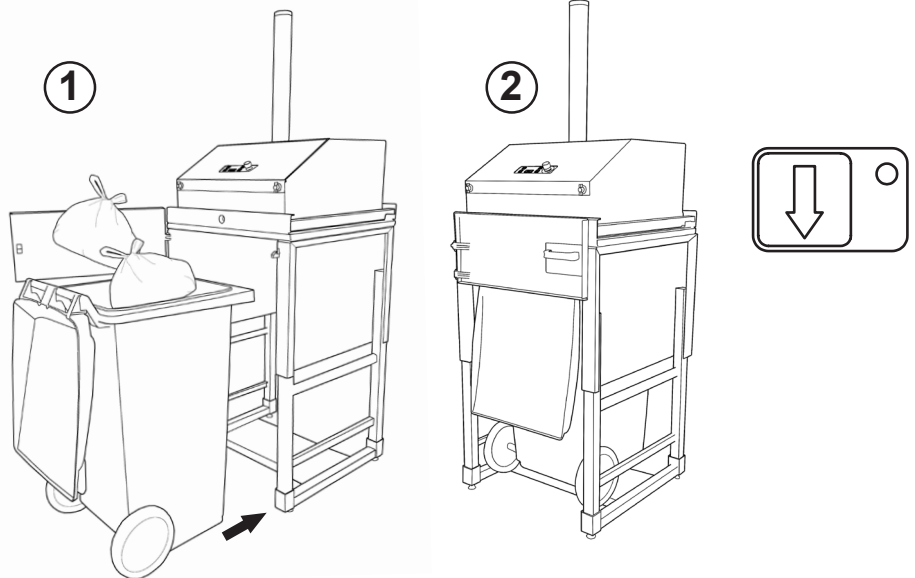

### DOUBLE

#### Compaction

Lock the front shutter before start.

- 5 Place the bins in the machine.
- 6 Distribute the waste evenly inside the bin.
- 7 Slide the press unit to the side you want to press. The start button will glow green - press the start button for a compaction cycle.

#### Empty bin

- 8 Slide the press unit to the side and pull out the bin.
- 9 Empty the bin and put it back in the machine.

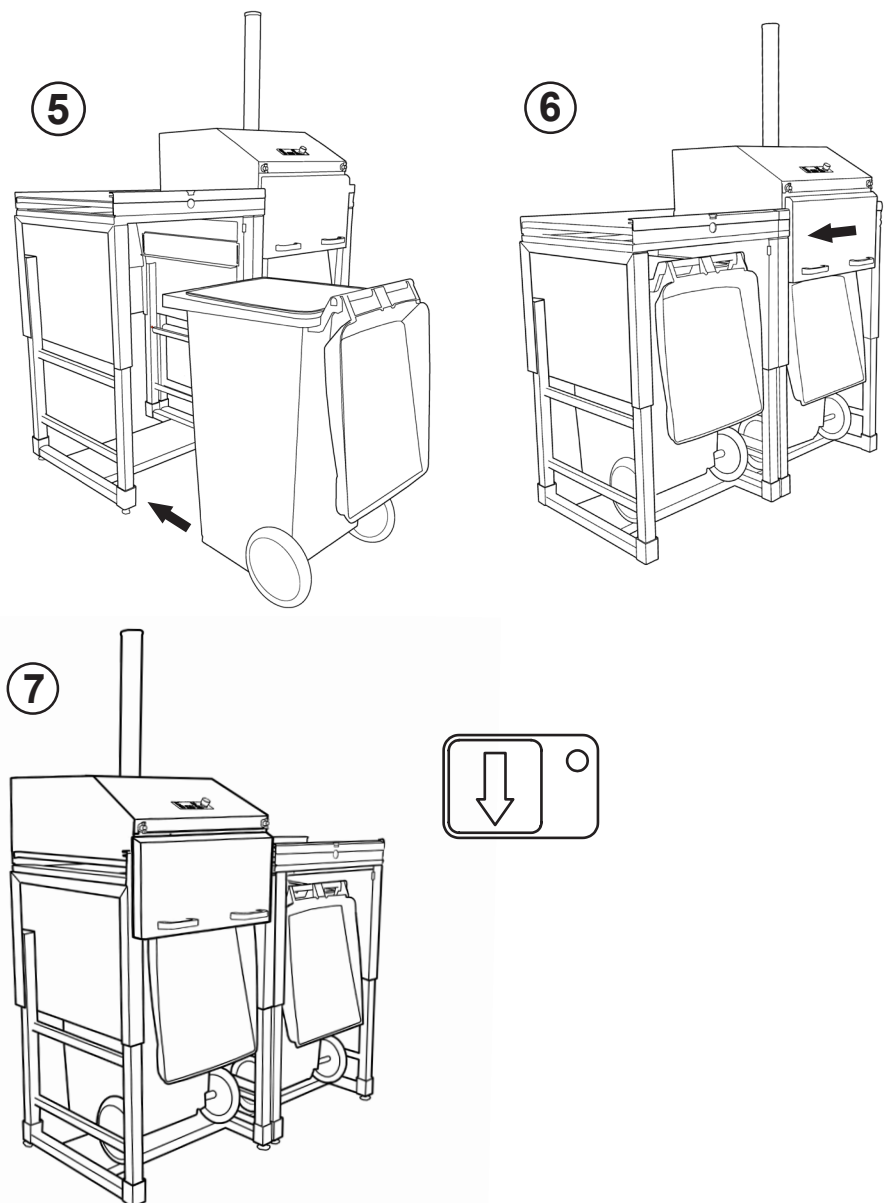



## WEEKLY INSPECTION AND MAINTENANCE

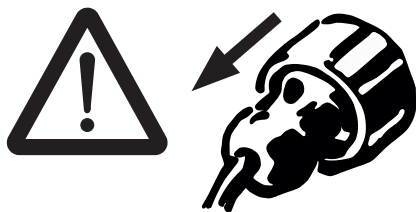

## NOTE!

During inspection and maintenance, service and the removal of trapped waste etc:

1. Disconnect the power to the machine by removing the plug from the wall socket.
2. Do not work inside the machine.

## ANNUAL CONTROL

The annual machine inspection should be performed by an authorized service technician approved by the manufacturer.

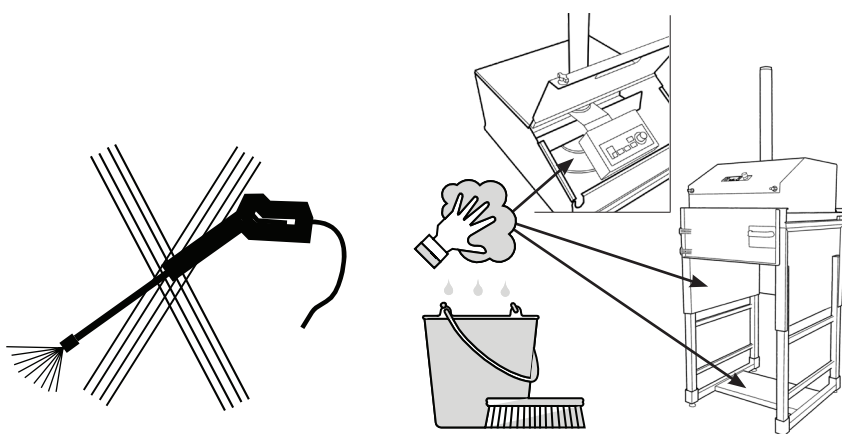

## TROUBLESHOOTING:

First, check:

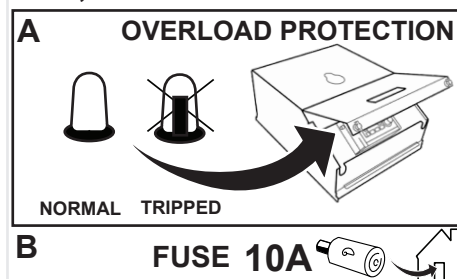

## SAFETY CHECKS

- Check the **shutter switch**: it must not be possible to start the machine if the upper shutter is open/opened.
- Check that the **emergency stop** is working.
- Check that all **covers and guards** are intact.
- Check that there are no oil leaks on the machine.
- Check that the electrical supply cable is intact and properly protected against impact.

If any faults are discovered in the functions listed above, the machine must not be used until it has been repaired by authorised service personnel.

Flashing service light = fault.

Fault messages can be read via the service light.

First, try removing the plug from the mains and then plugging it back in.

If the fault persists and the service key flashing again don't turn of the power: instead press the emergency stop button, after some seconds there will be a number of flashes, e.g. LED extinguished for 5,10 or 15 seconds followed by 1 to 9 flashes. (Example 5 second 3 flash or 10 seconds 2 flash.)

For optimal service help – mention the flashing message when reporting the fault.

Do not use the machine until an authorised service engineer has corrected the fault.

Service light, steady light = time for servicing. Contact your authorised service engineer.

The machine can continue to be operated.

**When changing the oil:** Contact the local authorities for guidance regarding the environmentally correct disposal of waste oil.

Miscibility must be taken into account when changing and/or topping up the oil.

The machine comes filled with mineral oil from the factory.



# English

## TECHNICAL SPECIFICATIONS

GENERAL DATA	4240	4360
Total weight single:	220 kg	240 kg
Total weight double:	320 kg	360 kg
Transport height:	2,100 mm	2,100 mm
<b>Dimensions:</b>		
A - Height, min:	2,100 mm	2,100 mm
max:	2,275 mm	2,275 mm
B - Width single:	750 mm	950 mm
C - Depth single:	920 mm	980 mm
D - Width double:	1,475 mm	1,900 mm
E - Depth double, min:	900 mm	970 mm
max:	990 mm	1060 mm
Depth with open door:	1,515 mm	1,790 mm
<b>Recommended space for machine in operation (working area):</b>		
Height:	2,275 mm	2,275 mm
Width single:	1,950 mm	2,150 mm
Width double:	2,675 mm	3,100 mm
Depth with open door:	2,115 mm	2,390 mm
<b>Noise level:</b>	< 62,3 (± 1.0) dB (A) (ISO 11200 & 11202)	

### Paint:

Two-part paint and powder coat with phosphatising as base.

### ELECTRICAL DATA

Operating power:	230V, 50Hz
Operating voltage:	24V
Electric motor:	1,1 kW
Fuse rating:	10A
Protection class:	IP 55

### HYDRAULIC DATA

Working pressure:	55 bar
Overload pressure:	90 bar
Press force:	1.5 ton
Surface pressure:	1,17 kg/cm <sup>2</sup>
Cycle time total:	29 sek.
Cylinder stroke length:	640 mm
Oil volume:	6,0 liter
Recommended oil: +5°C till +40°C	ISO VG 32-68, Mineraloil
Below +5°C	A special oil or heater should be used at lower temperatures.

## DIMENSIONAL DIAGRAM

### SINGLE

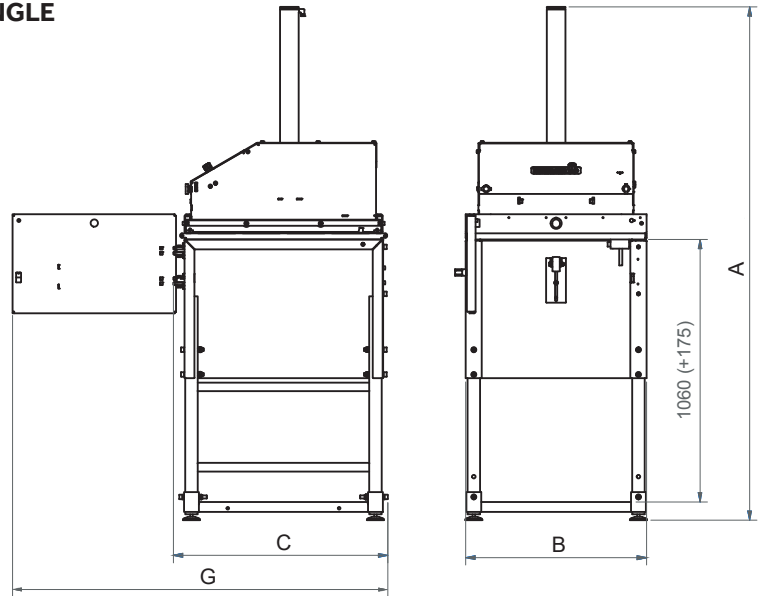

### DOUBLE

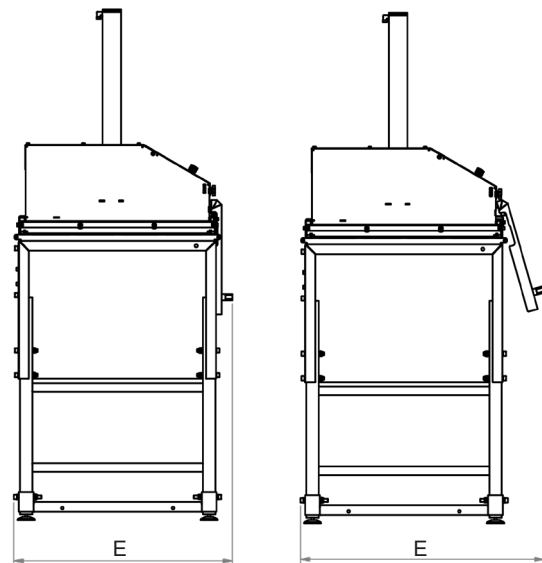
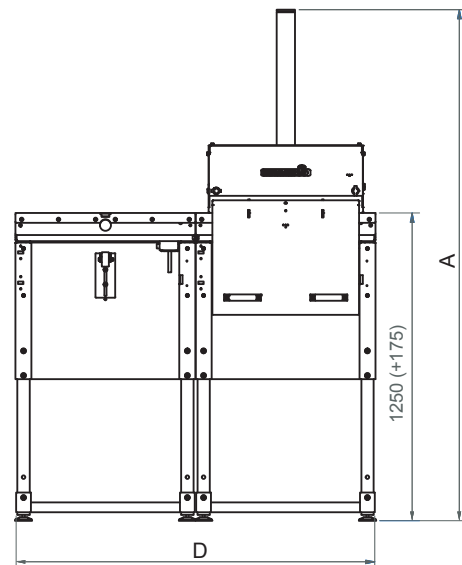

TRANSPORT  
SINGLE

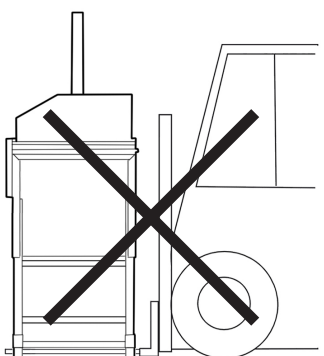
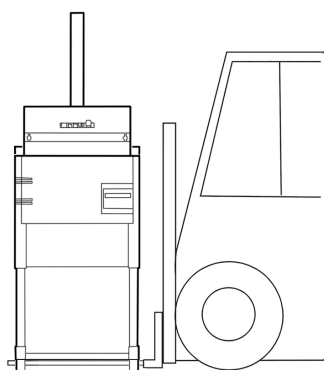
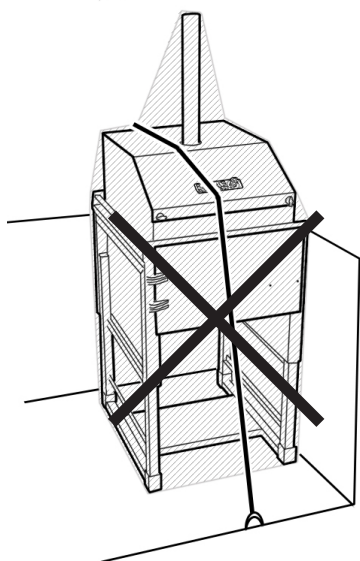
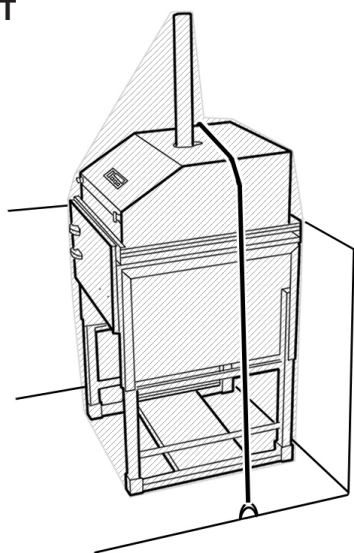

DOUBLE

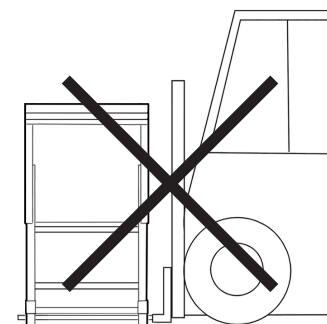
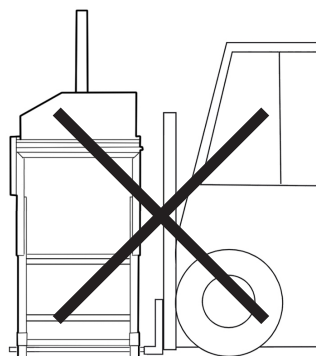
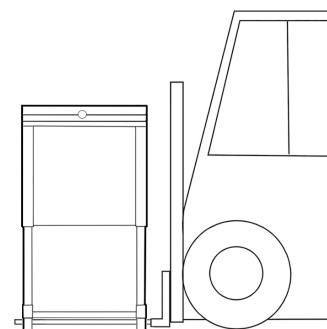
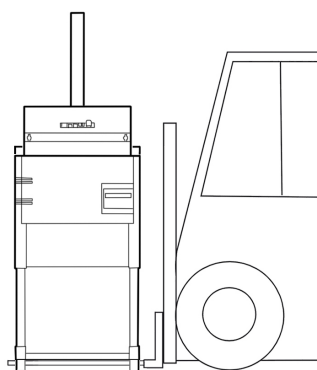
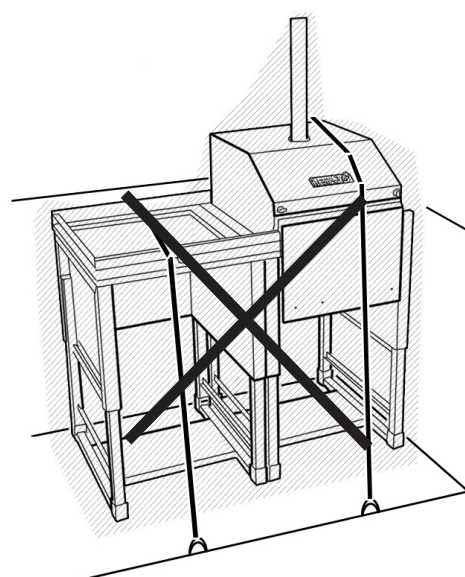
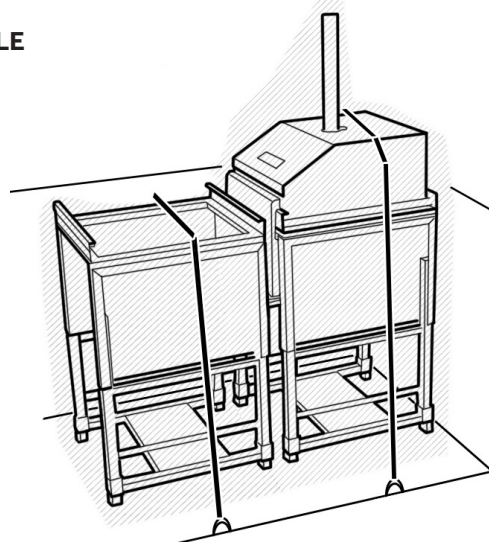

# English

## INSTALLATION

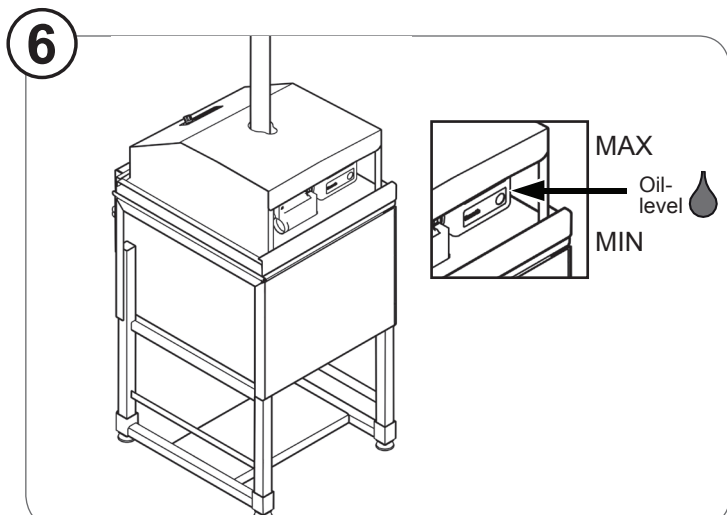
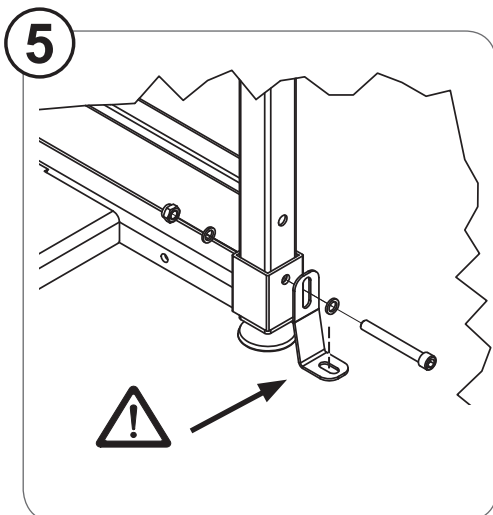
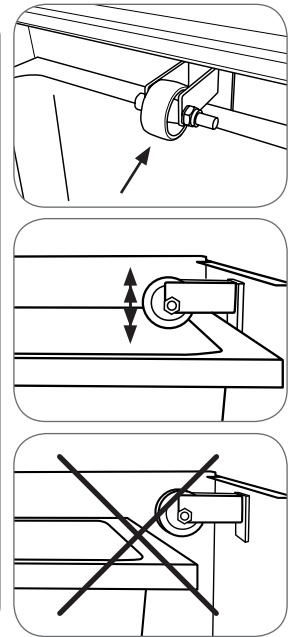
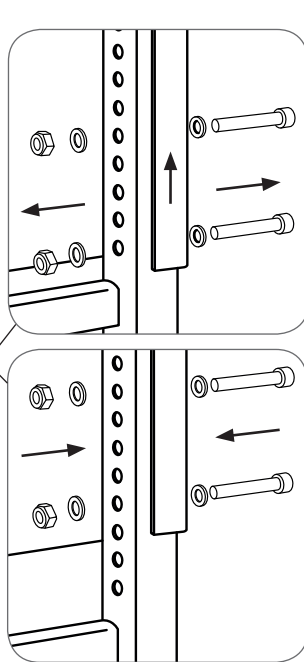
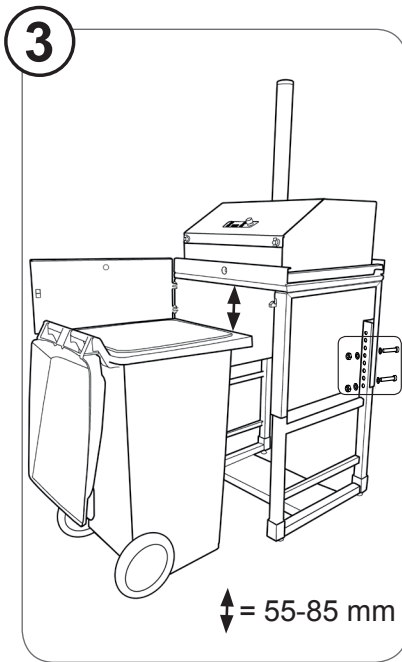
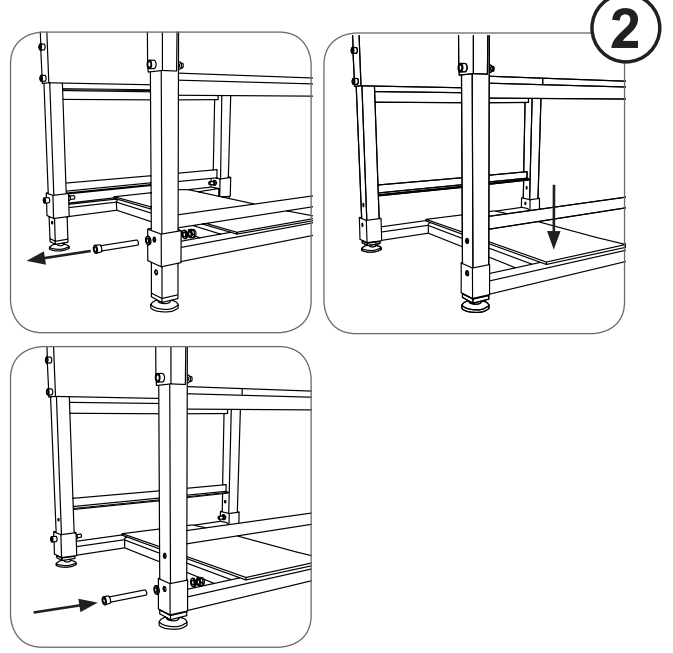
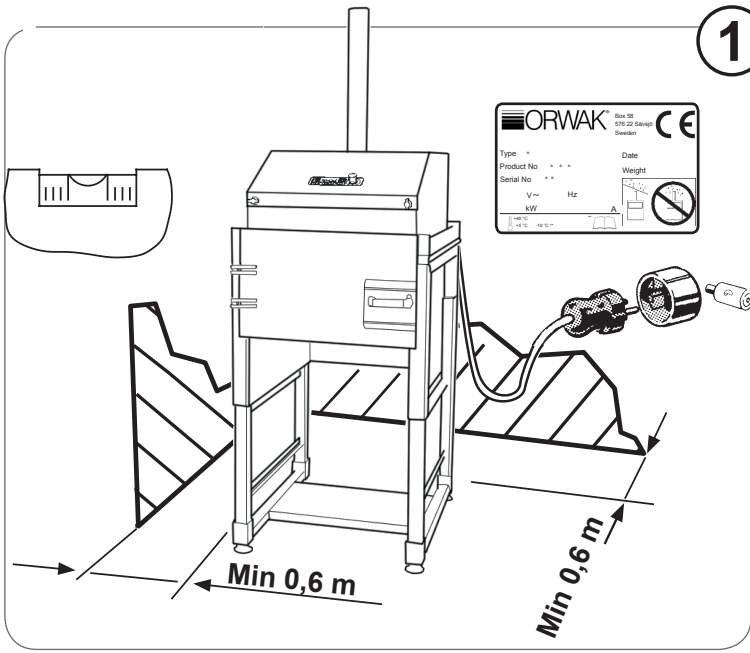

## EC DECLARATION OF CONFORMITY



We Orwak AB  
Svetsaregatan 4  
SE-576 33 Sävsjö, Sweden  
Tel: 46-382-15700

declare under our sole responsibility that the product model

**4904240-00 – 4904240-99**  
**4904240-S001 – 4904240-S999**  
**4904360-00 – 4904360-99**  
**4904360-S001 – 4904360-S999**

to which this declaration relates is in conformity with the following standards or other normative documents in accordance with the provisions of Directives

2006/42/EEC (Machinery Directive)  
2014/30/EU (EMC Directive)  
2011/65/EU (RoHS II)

The machine fulfils the requirements of PL =  
c and category 1 according to EN ISO 13849-1

EN 60204-1 (Safety of Machinery – Electrical Equipment of Machines)  
EN 61000-6-1 (EMC Immunity for residential, commercial and light-industrial environments)  
EN 61000-6-2 (EMC Immunity for industrial environments)  
EN 61000-6-3 (EMC Emission standard for residential, commercial and light-industrial environments)  
EN 61000-6-4 (EMC Emission standard for industrial environments)  
EN ISO 13849-1 (Safety of Machinery – Safety-related parts of control systems)

Sävsjö 2023-02-28

A handwritten signature in blue ink, appearing to read "Philip Karlsson", with a horizontal line extending to the right.

Philip Karlsson

Compiler of technical documentation

# ELECTRICAL DIAGRAM

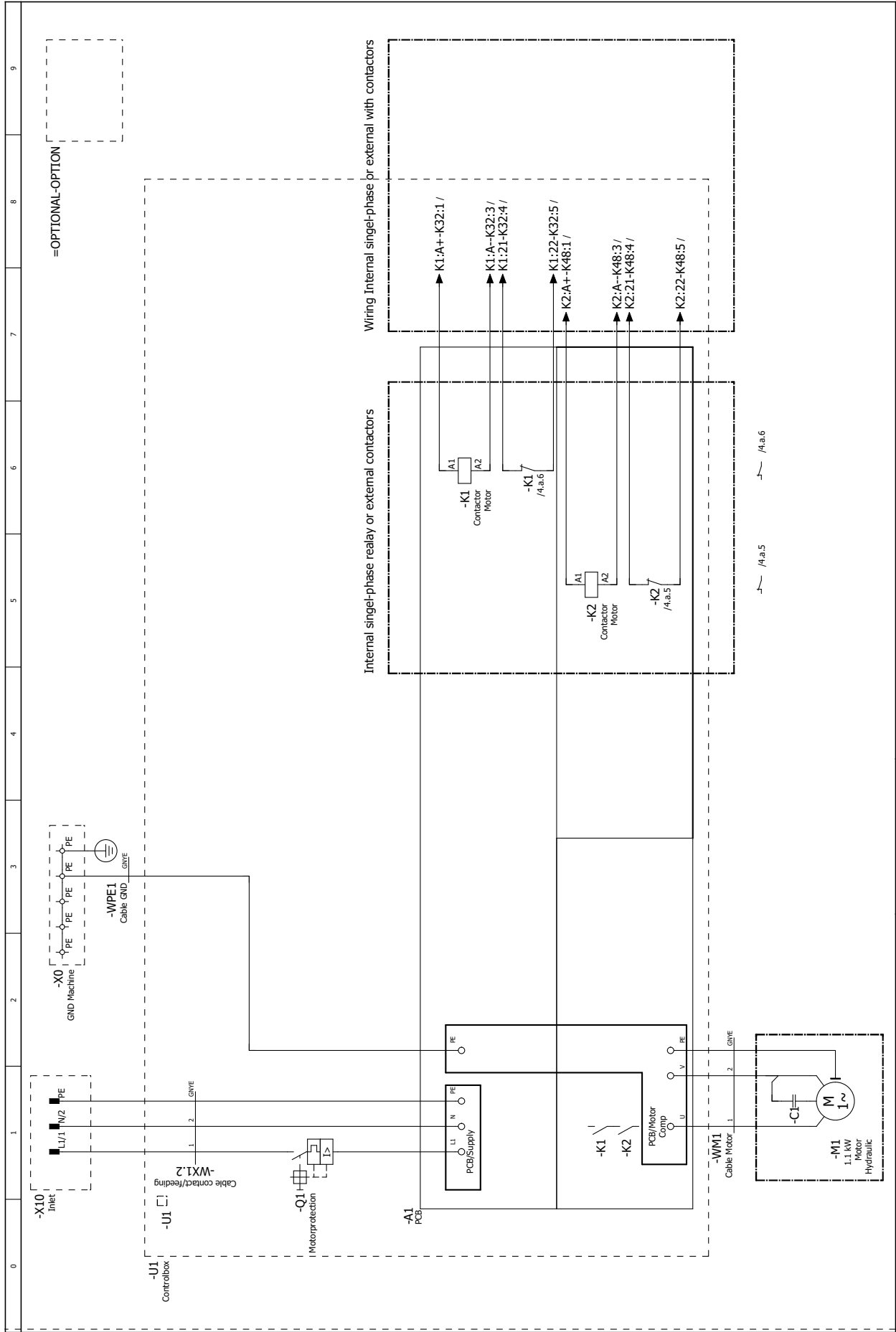

Revision	Date	Name	Checked	Original	Date	Standard	Description:	From serial number:	Sheet	4.a
	2020-10-15					Standard	1x230V, 1x115V Included in document: 3110/3115/4240/4360	4871758-02	4.a	
							Sheet description: Circuit diagram			

# ELECTRICAL DIAGRAM

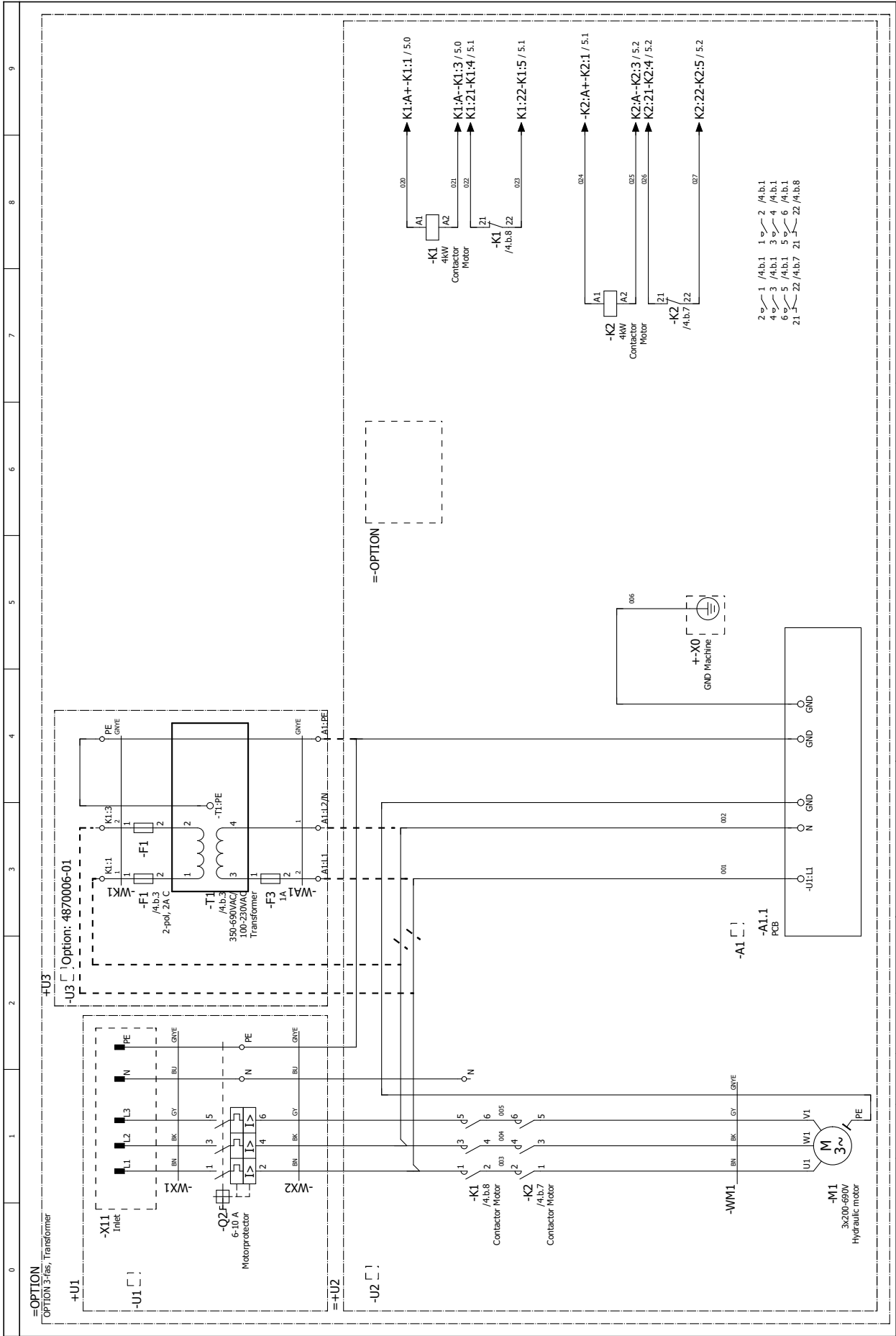

Revision	Date	Name	Original	Checked	Editor	Standard	Date	Description
	2020-10-15					Standard		3x200-230V, 3x350-690V Included in document:3110/3115/4240/4360
								Sheet description: Circuit diagram

From serial number: ...Serie number	Sheet 4.b
Eschema number: 4871758-02	

# ELECTRICAL DIAGRAM

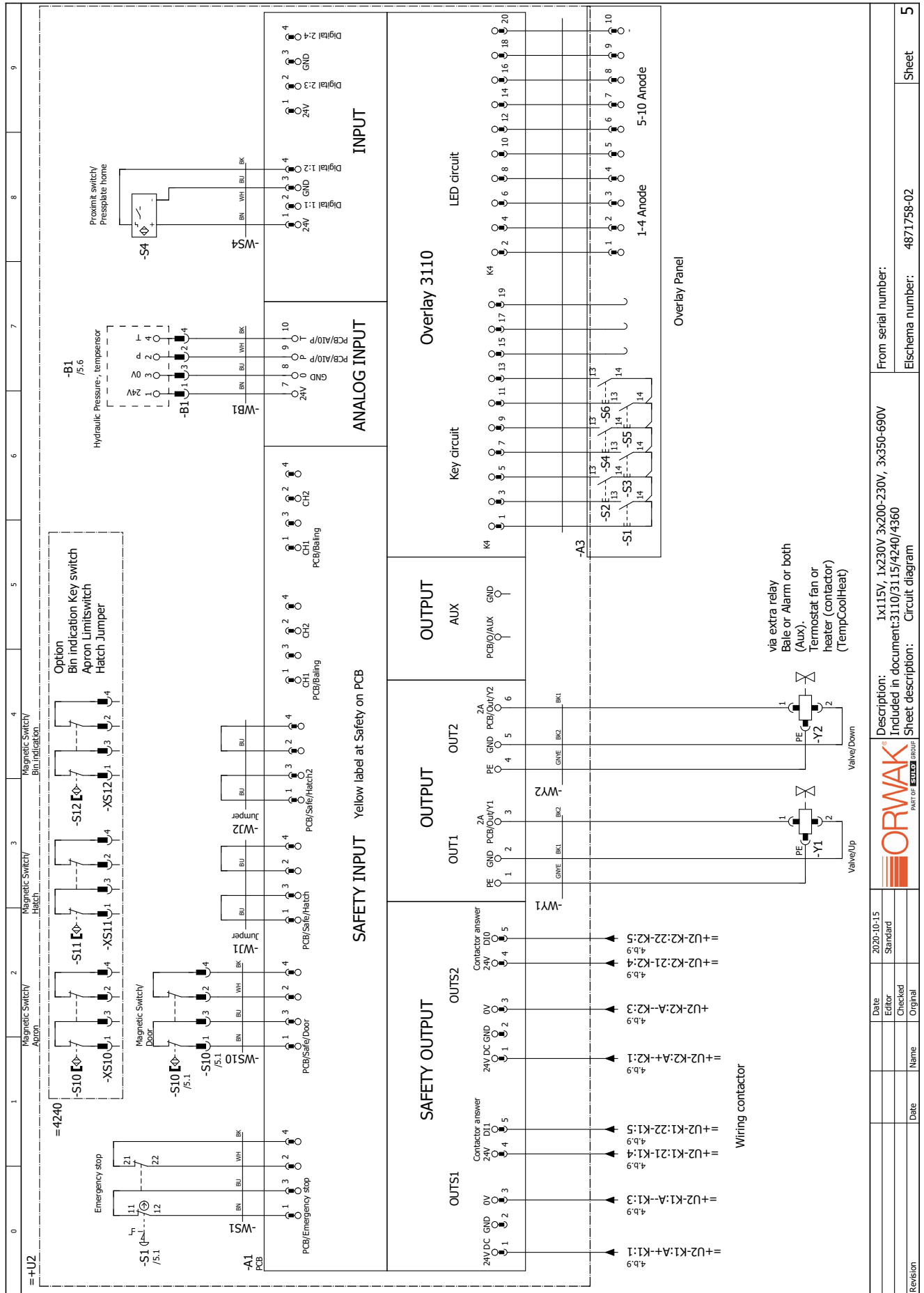

Revision	Date	Name	Date	Standard
	2020-10-15			Standard
				Checked
				Original

Description: 1x115V, 1x230V 3x200-230V, 3x350-690V  
 Included in document: 3110/3115/4240/4360

From serial number: 4871758-02  
 ESchema number: 4871758-02



# HYDRAULIC DIAGRAM

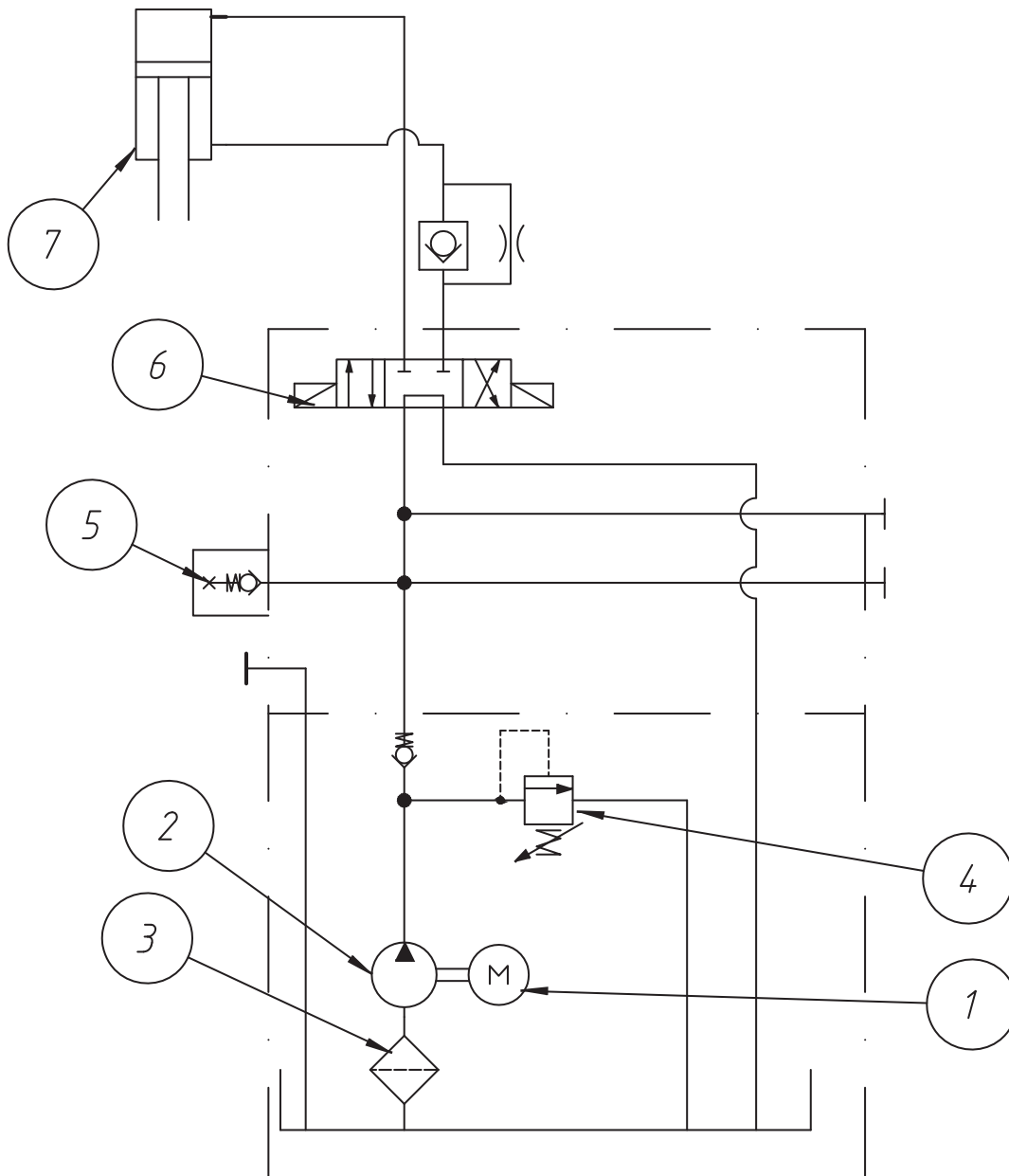

## Item Description

No	English
1.	Electrical motor
2.	Pump
3.	Suction filter
4.	Overload valve
5.	Output pressure gauge
6.	Directional valve
7.	Press cylinder





# COMPACTION SOLUTIONS FOR MOST TYPES OF WASTE

---

ORWAK develops solutions for sorting and recycling waste materials that improve business efficiency, contribute to a cleaner working and natural environment to provide the best total waste handling economy.

We offer an innovative range of products that promotes sorting at source and make waste management more profitable.

ORWAK AB  
Svetsaregatan 4  
S-57622 Sävsjö  
SWEDEN  
Tel: +46-(0)382-15700  
info@orwak.com

**ORWAK.COM**

 **ORWAK**<sup>®</sup>  
PART OF **SULO** GROUP